

**1** Connect the tubes for the horizontal lengths.

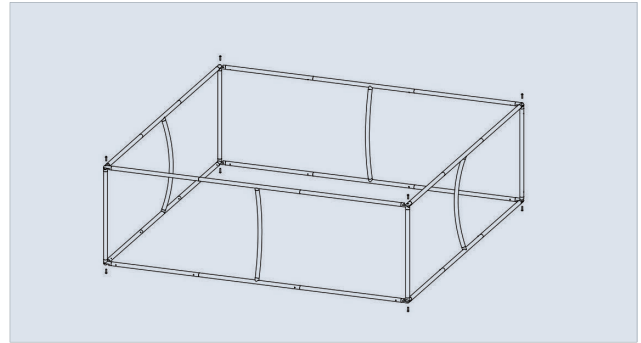

**2** Connect the vertical tubes to complete the framework and screw together at the bottom.

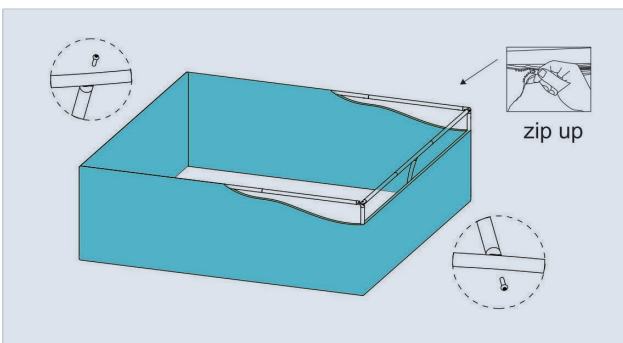

**3** From bottom to top, wrap the frame with the graphic, then zip up.

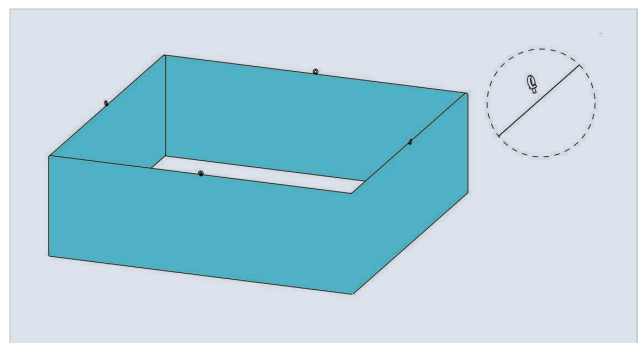

**4** Install the rings, then pass the hanging wires through opposite rings.

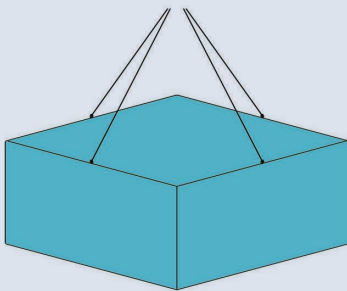

**SQUARE**

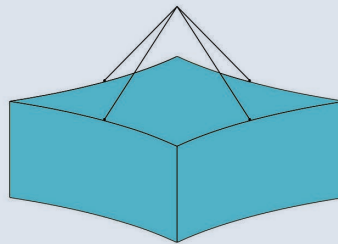

**CURVED SQUARE**

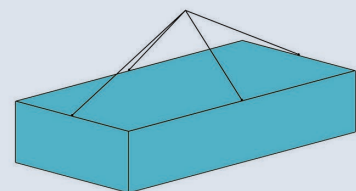

**RECTANGULAR**

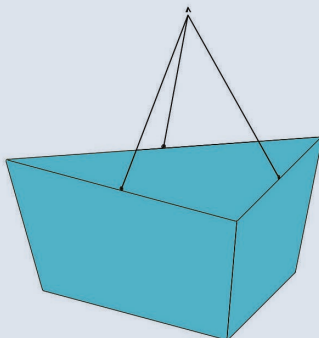

**TAPERED TRIANGLE**

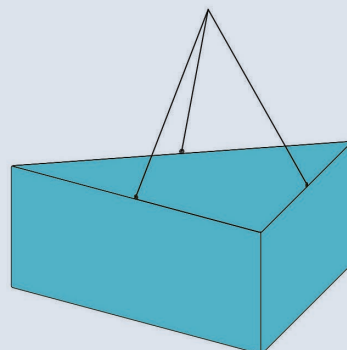

**TRIANGLE**

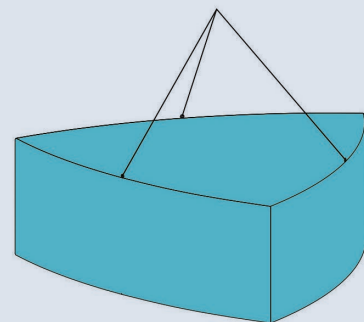

**CURVED TRIANGLE**